

**STABILA®**



...sets standards



## Receiver REC 300 Digital



Operating instructions

## Operating instructions

The STABILA REC 300 Digital is a simple-to-use receiver for the rapid capture of rotating lasers. The REC 300 Digital receiver can receive laser beams from rotation lasers, even when these are invisible to the naked eye.

The distance to the "on line" position is indicated digitally

We have endeavoured to explain the unit's handling and functioning in as clear and comprehensible manner as possible. If, however, you still have any unanswered questions, we should be pleased to provide advice over the telephone at any time on the following telephone number: 0049 / 63 46 / 3 09-0

## Main components

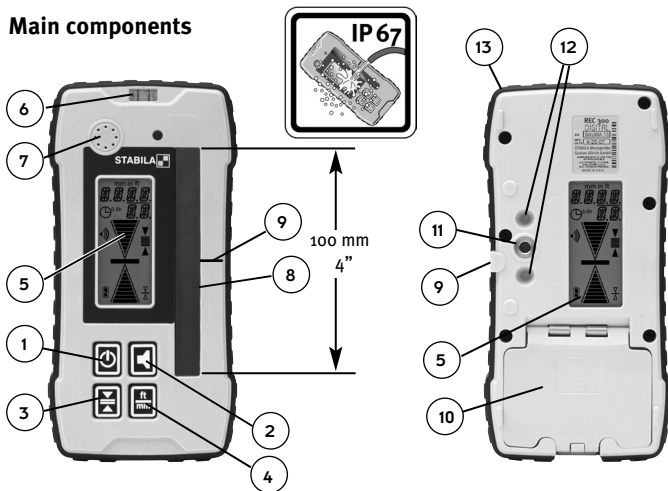



1. ON/OFF button
2. Volume button
3. Accuracy button
4. Measuring unit button
5. LCD
6. Vial
7. Beeper

8. Laser receiver glass 100 mm / 4"
9. "In line" marks
10. Battery compartment cover
11. Fixing thread for the clamp
12. Clamp Guides
13. Shock protection

## Getting started

Press the ON/OFF button (1). An audio signal and a short flash from the display will confirm, that the instrument is switched on. The instrument will now calibrate itself.

1.   
ON/OFF button
2.   
Automatic calibration

Press the ON/OFF button (1) quickly once (2sec) to switch the instrument off. If the instrument is not used, it will automatically switch itself off after 30 minutes.

## Height difference display: analogue

20 display steps indicate the divergence from the centre of the laser line. The central bar indicates the “in line” position of the REC 300 Digital. The arrow increases in size as the distance from the “in line” position increases.

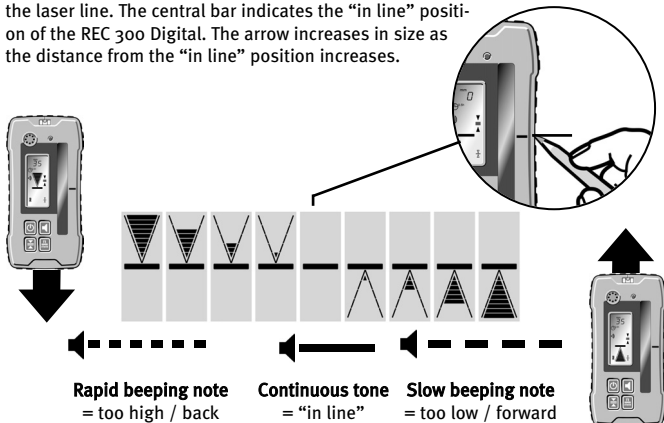

## Audio signals



### Setting the volume

The volume is increased/decreased by repeatedly pressing the button (2): (a) Loud (a), soft (b) or off.

- 2 If the instrument is set to “silent” only a short beep is emitted when the laser beam is received.



## Height difference display: digital

The distance to the “on line” position is indicated by digital figures

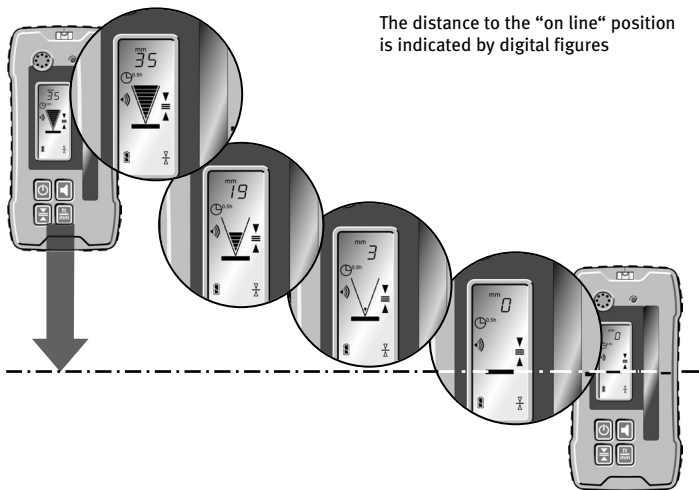

## Measuring modes

### Setting the accuracy level



The icons appear permanently



**Fine**

± 1,0 mm  
± 0,05 in  
± 1/16 in  
± 0,005 ft



**Coarse**

± 5,0 mm  
± 0,2 in  
± 1/4 in  
± 0,02 ft

The display appears only briefly

~ 1 sec

The setting selected remains in memory after the unit is switched off.

### Setting the measuring unit



The display appears only briefly ~ 1 sec



The setting selected remains in memory after the unit is switched off.

## Replacing the batteries

### LCD



**Full:**  
Batteries  
OK



**Half:**  
Initial  
Warning



**Empty:**  
Approximately  
30 Minutes  
Remaining



**Flashing:**  
Change  
Batteries!

Slide the battery cover (10) in the direction of the arrow and insert new batteries in accordance with the symbols in the battery compartment.

2 x 1,5V  
Mignon cells Alkaline,  
Size AA, LR6

**Mignon**  
**AA**  
**LR6**

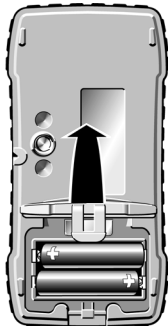

Remove the batteries if the unit will not be used for a long period !



Battery compartment cover. Water-tight. Protection against water and dust is ensured by the pressure of the cover against the seal. IP 67.

### Bracket

1. Securing screw - for securing to the rear side of the receiver.
2. Guide cones - assist in quickly and securely fixing the bracket to the receiver.
3. Reading reference
4. Securing knob. Turning the securing knob fixes / releases the clamp with the receiver to / from the levelling staff.
5. Moveable clamping jaw - for fixing to the levelling staff.

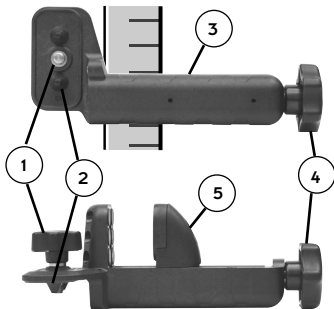

## Care and maintenance

**Cleaning:** Please do not remove dust and dirt from the receiving or display window by using dry cloths or abrasive materials as this procedure scratches the windows. A soft cloth and mild soap and water are effective.

The unit may be submerged under water or sprayed with a low pressure hose if necessary. Do not use any other fluids other than water or glass- cleaner, as they may attack polymer components.

## Prohibited Uses

- Operation without instruction.
- Operation other than the intended uses.
- Opening the detector, except the battery compartment.
- Modification or conversion of the detector.



## Important information

- The person in charge of the detector must understand the instructions in this manual and ensure other users do also.
- Periodically carry out test measurements, particularly after the detector has been subjected to abnormal use and before and after important measurements.

## Positioning and adjustment of the instrument.

When setting up the instrument, take care that the laser beam does not produce any unwanted reflections from reflective surfaces.

These reflections may also be captured by the receiver and produce incorrect readings.

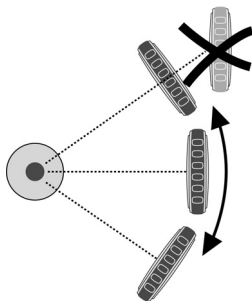

## Recycling programme for our EU customers:

In accordance with the WEEE regulations, STABILA provides a disposal programme for electronic products at the end of their service life.

For more details, please contact:

[www.STABILA.de](http://www.STABILA.de) / Recycling

or:

0049 / 6346 / 309-0



## Technical data

Accuracy	Fine:	± 1,0 mm	0,05 in	1/16 in	0,5/100 ft
	Coarse:	± 5,0 mm	0,20 in	1/4 in	2,0/100 ft
Detectable Spectrum:		610 nm - 780 nm			
Beeper Volumes:		Loud: ~ 105 dBA		Low: ~ 85 dBA	
Batteries:		2 x 1,5V Mignon cells Alkaline , Size AA,LR 6			
Operating life:		70 hours			
Automatic Shut Off:		30 minutes			
Operating temperature range:		-20°C to +60°C			
Storage temperature range:		-40°C to +70°C			

Subject to technical modifications.

## Guarantee terms and conditions

Stabila provides a guarantee against deficiencies and faults in the assured characteristics because of material or manufacturing faults for a period of 24 months from date of purchase. Any faults will be eliminated at Stabila's own discretion either by repairing or replacing the unit. Stabila accepts no wider claims.

No liability is accepted for any faults due to inappropriate treatment (e.g. damage caused by the unit falling, operation with the wrong voltage or type of current, use of unsuitable current supply sources) or for any autonomous changes made to the unit by the purchaser or a third party.

Also no claims under guarantee are accepted for natural wear and tear or any small faults that do not significantly affect the unit's operation.

Any guarantee claims must be made via the dealer on the duly completed guarantee form (see last page) to be returned with the unit.