

# PLOTT

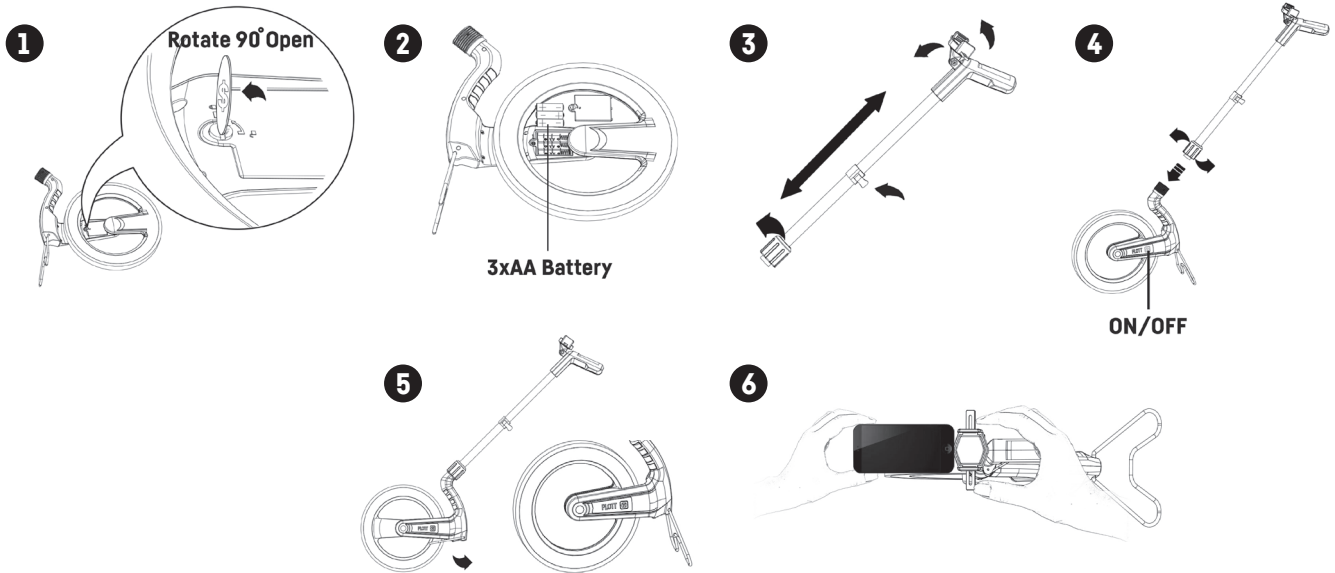

## Using Carta

# Assembling Carta



## Step 1.

Download the “Plott - Creativity into reality” app



**Plott-Creativity into reality**

Plott, Inc.



Plott-Creativity into reality

Plott Tools

Everyone

Add to Wishlist

## Step 2.

Open the app & press the “Let’s Plott” button



LET'S PLOTT +

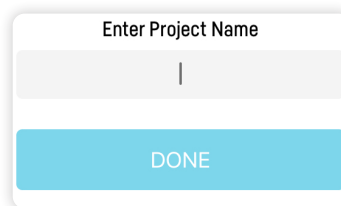

Open



Press



Name



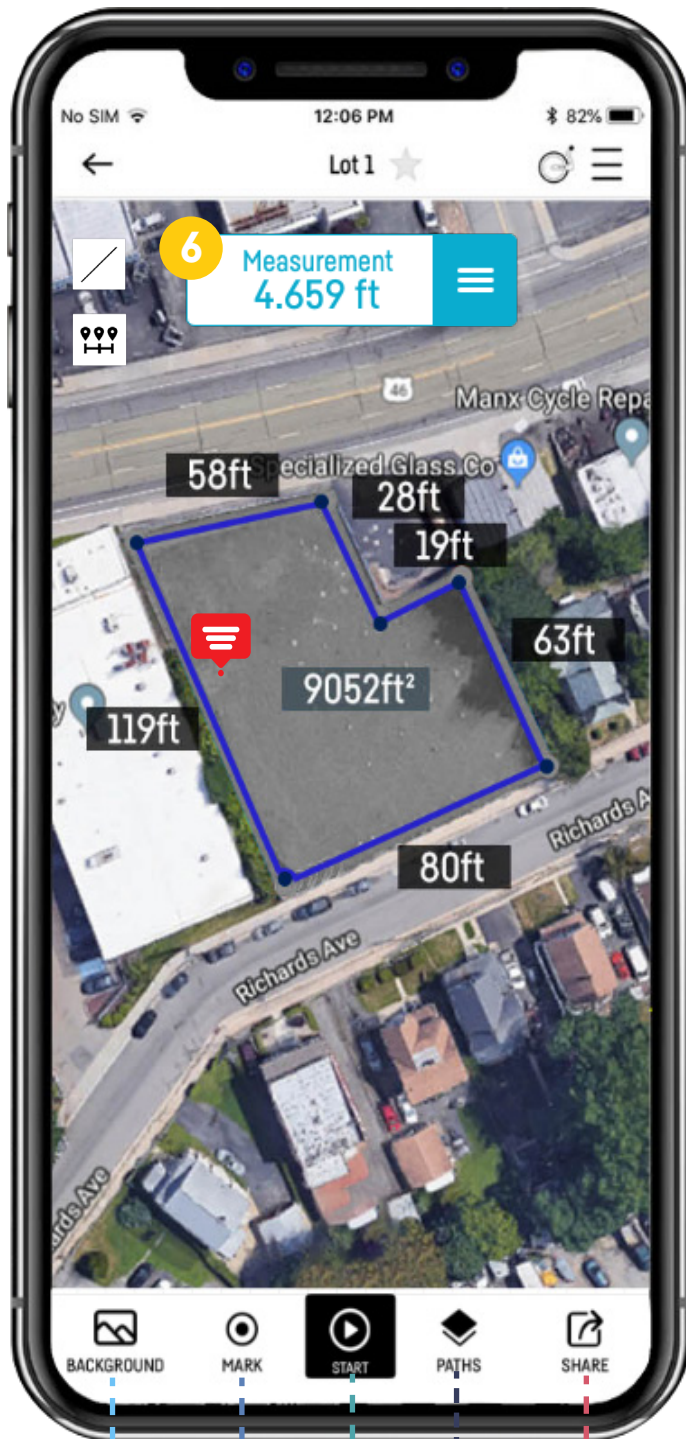

Select Carta

# Get familiar with the interface



- 1 Background**  
Take or select a picture for scale and context
- 2 Mark**  
Record a measurement and mark points on your project
- 3 Start**  
Begin measuring
- 4 Paths**  
Add, delete, or hide Paths
- 5 Share**  
Send a Plott file of your design to others
- 6 Measurements Menu**  
Manage all your measurements

 **Set Distance Alarm**  
Alerts for specific distances

 **Line Modes**  
Free line mode allows you to accurately measure curves and turns while straight line mode is great for measuring straight lines

 **Notes**  
Press and hold the screen to add notes

 **Guide Mode**  
Navigate to your marked points from a known starting point

*[appears when a path is selected]*

## Step 3.

## Getting Started



Once your phone is mounted to Carta, **press the start button**

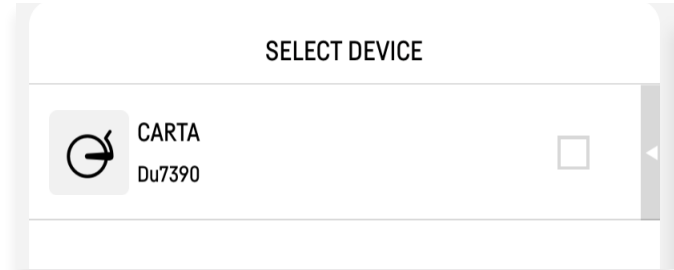

The app will prompt you to **connect to Carta**. Make sure your **device is ON**

## Step 4.

## Plotting your project

Begin walking with Carta. Your measurement will be displayed at the top.



Press the mark button to mark specific points in your project.

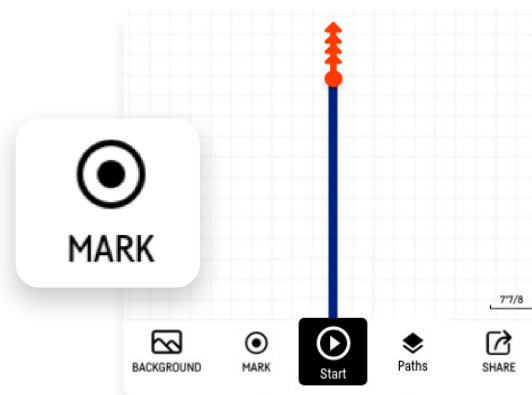

*Carta will guide you back to points you marked while in Guide Mode.*

## Step 5.

## Adding finishing touches to your project

You can add background satellite images to your projects, as well as written & picture notes. That way others will be able to see your comments when you share it.

*Background image can be adjusted & paths when selected can be rotated as well.*



Background Button

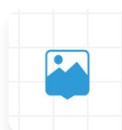

Picture Note Icon

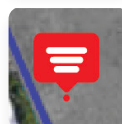

Note Icon

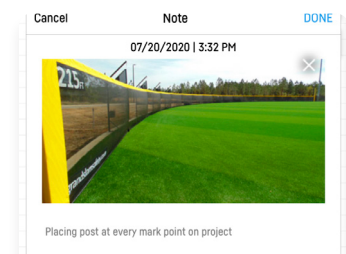

Note Window

# Step 6.

## Guide mode

Guide mode allows you to retrace your steps & go back to your marked points. When you're ready, just select your path by pressing it and the start button will switch to Guide Mode button. Press Guide Mode, select the points you want to go to, and press "Change Reality" to begin guiding. When starting make sure you are in the same starting location where you plotted from, and facing towards your first marked point.

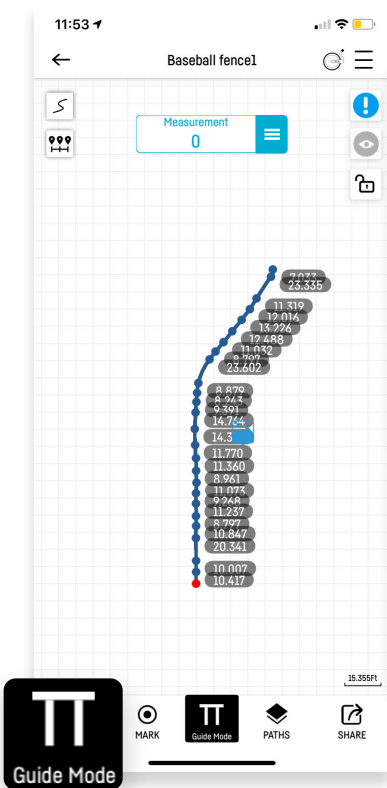

**Select Path  
Press Guide Mode**

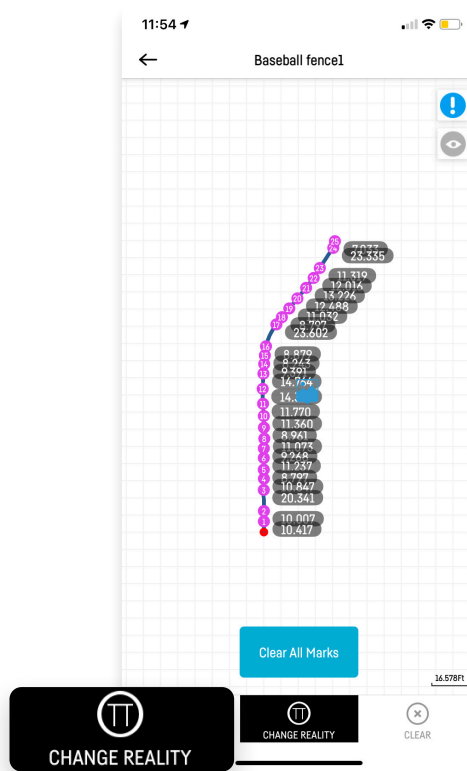

**Select Points  
Press Change Reality**

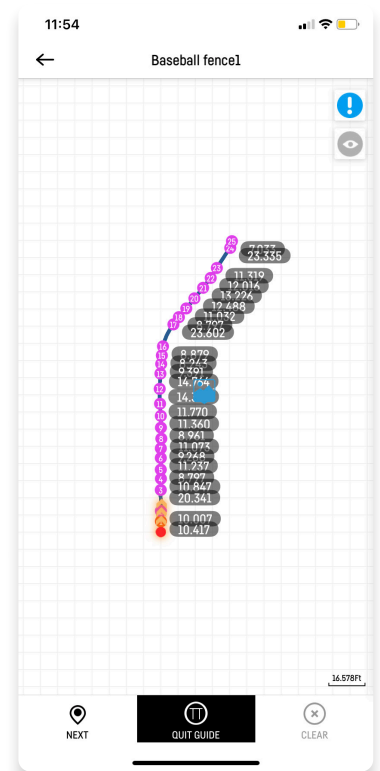

**Begin Walking to  
Point**



This button will tell Carta to move on to the next point



This button will tell Carta to end guide mode



